

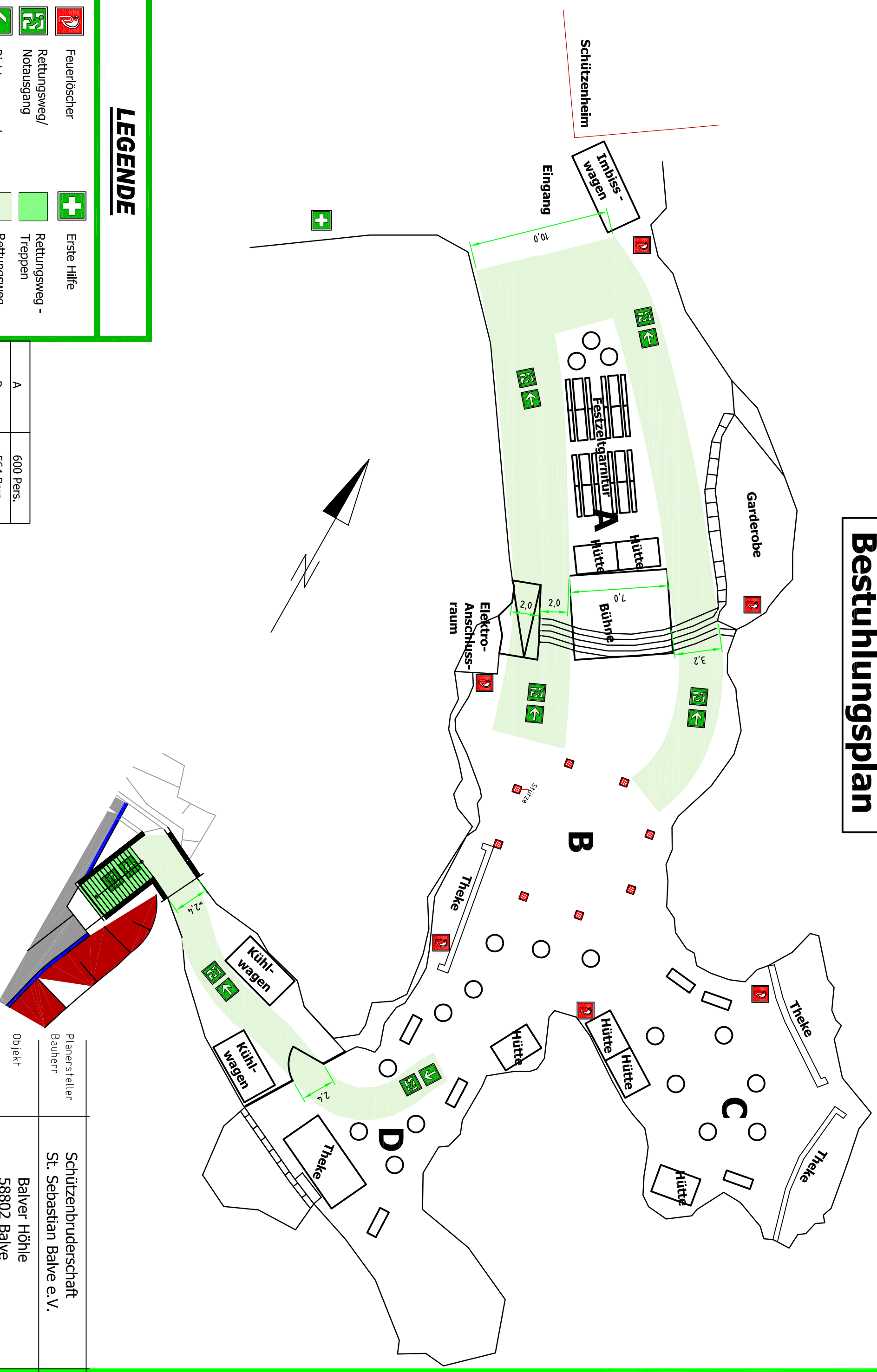





Bestuhlungsplan

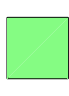

LEGENDE

-  Feuerlöscher
-  Erste Hilfe
-  Rettungsweg/Notausgang
-  Rettungsweg - Treppen
-  Richtungsangabe
-  Rettungsweg

A	600 Pers.
B	564 Pers.
C	288 Pers.
D	376 Pers.
Summe	1828 Pers.

Planersteller Bauherr	Schützenbruderschaft St. Sebastian Balve e.V.		
Objekt	Balver Höhle 58802 Balve		
Veranstaltung	Apres - Ski		
Datum:	Aug 2010	Maßstab:	1:250
gez.:		Plan-Nr.:	22